

STATE OF NORTH CAROLINA
DEPARTMENT OF TRANSPORTATION
HIGHWAY DIVISION 6

PLANS

Let Date: November 2, 2022

CONTRACT ID: DF00418

TIP NO.: -----

FEDERAL AID NO.: STATE FUNDED

WBS ELEMENT NO.: 2023CPT.06.07.20782.1

ROUTE NO.: VARIOUS SR

LOCATION: VARIOUS

COUNTY: ROBESON

TYPE OF WORK: ASPHALT SURFACE TREATMENT – DOUBLE SEALS

LENGTH OF PROJECT: 32.521 MILES

**This electronic collection of documents is provided
for the convenience of the user
and is Not a Certified Document –**

**The documents contained herein were originally issued
and sealed by the individuals whose names and license
numbers appear on each page, on the dates appearing
with their signature on that page.**

**This file or an individual page
shall not be considered a certified document.**

Robeson County BST Fall 2022

Rennert
Pop. 391



Contract Number: DF00418
WBS: 2023CPT.06.07.20782.1

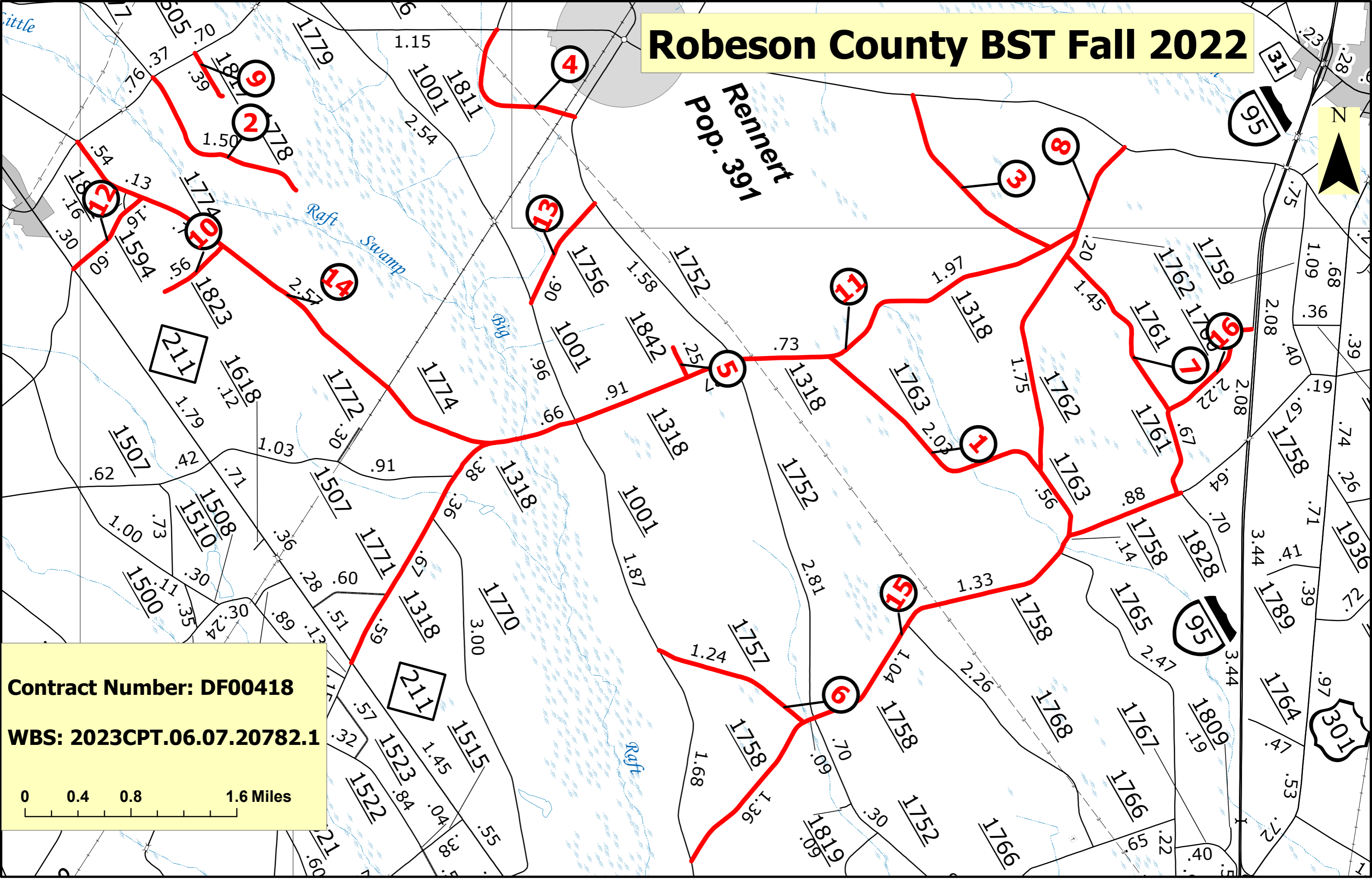
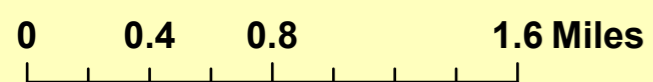

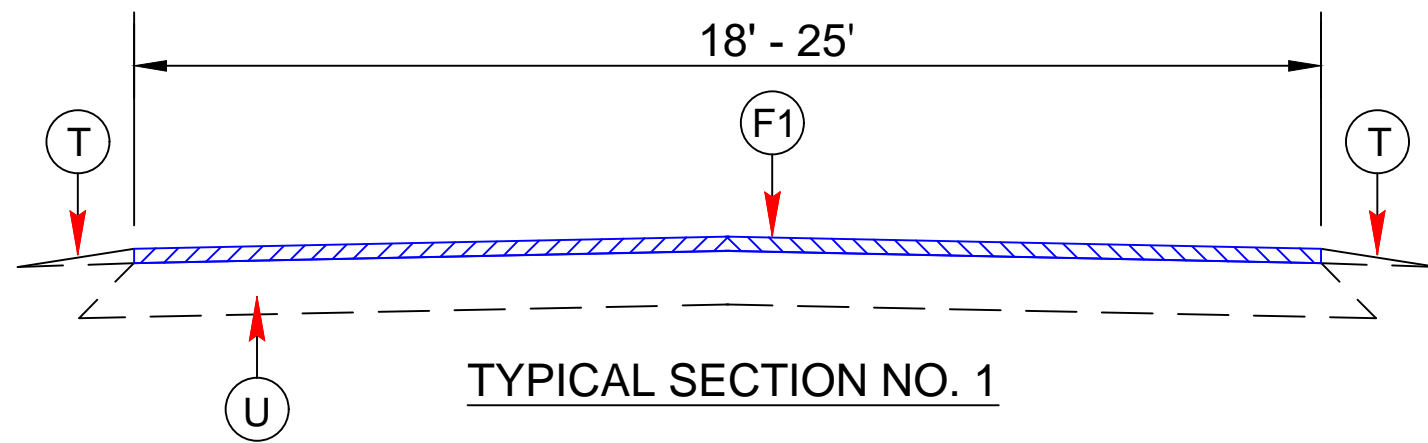

PAVEMENT SCHEDULE	
F1	DOUBLE SEAL PLACED ACCORDING TO THE SPECIAL PROVISIONS
T	EXISTING SHOULDER
U	EXISTING ASPHALT

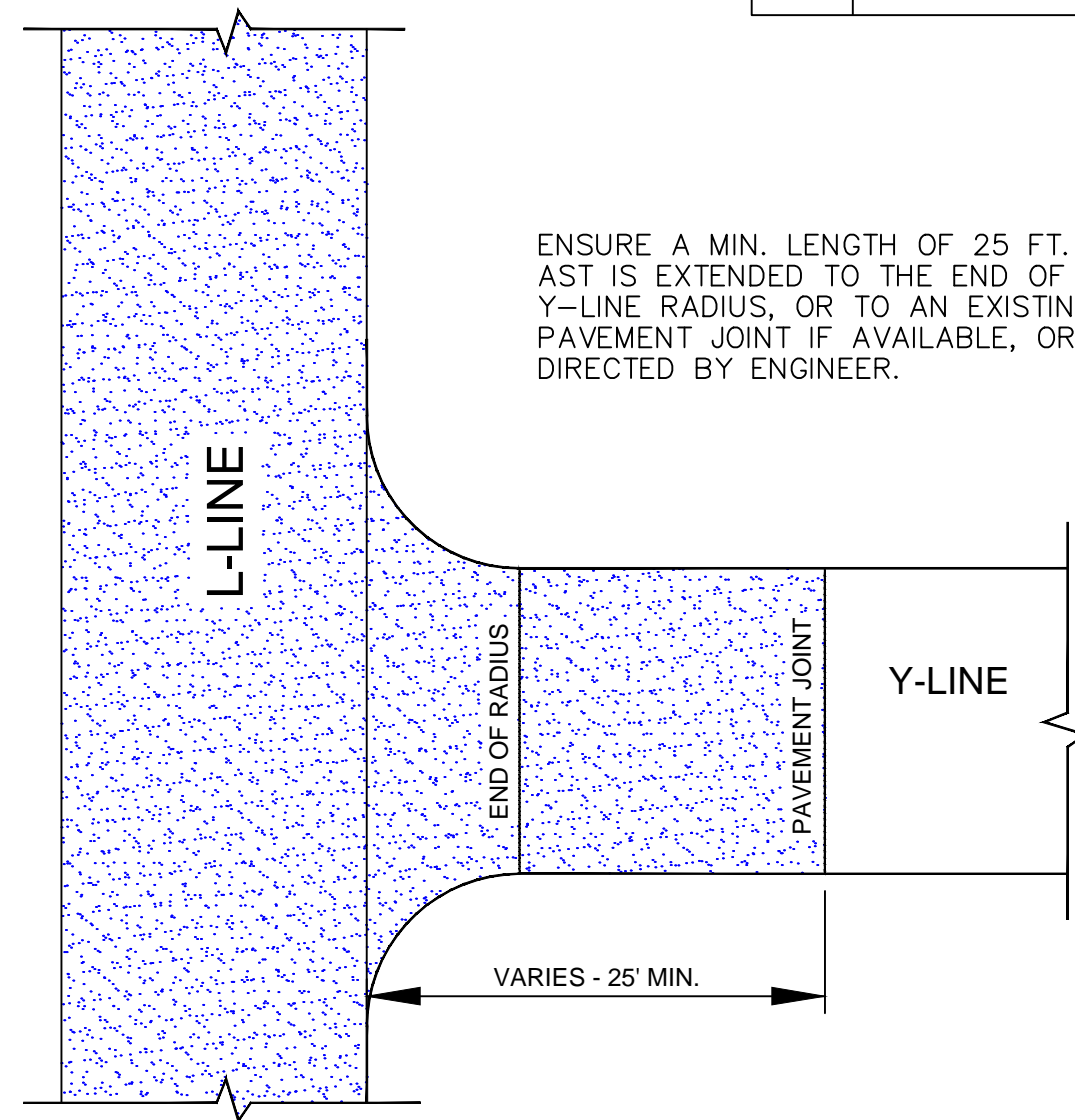

DETAIL 1
Y-LINE INTERSECTION TREATMENT

SIGNING FOR ASPHALT SURFACE TREATMENT

LEGEND

- PORTABLE SIGN
- STATIONARY SIGN
- DIRECTION OF TRAFFIC FLOW

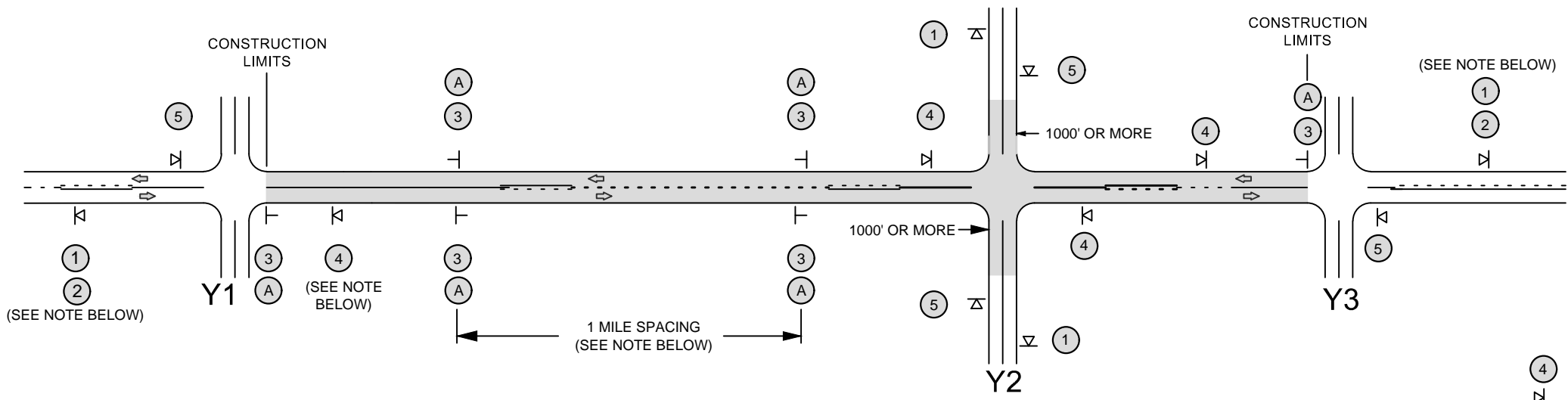

MAINLINE (-L-) SIGNING

-Y- LINE SIGNING

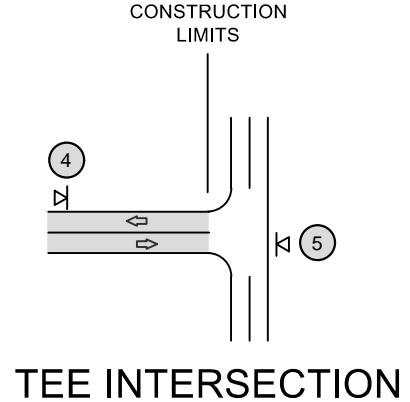

SIGNING NOTES AND PLACEMENT PER DIRECTION	<p>① ROAD WORK AHEAD W20-1 48" X 48"</p> <p>② NEXT XX MILES W7-3aP 24" X 18"</p>	<p>- PLACE 1000' PRIOR TO BEGINNING OF CONSTRUCTION LIMITS. ONLY USED ON -Y- LINES IF RESURFACING LIMITS EXTEND 1000' ALONG -Y- LINE.</p> <p>- SIGN #2 ONLY USED WHEN RESURFACING LIMITS ARE 2 OR MORE MILES IN LENGTH. ROUND UP TO THE NEAREST WHOLE NUMBER. DO NOT USE FRACTIONAL OR DECIMAL NUMBERS.</p>
	<p>③ LOOSE GRAVEL W8-7 48" X 48"</p> <p>UNMARKED PAVEMENT SP 48" X 48"</p>	<p>- ALTERNATE THE FOLLOWING TWO SIGNS:</p> <p>- STARTING WITH "LOOSE GRAVEL" (W8-7) FOLLOWED BY "UNMARKED PAVEMENT".</p> <p>- PLACE INITIALLY AT THE CONSTRUCTION LIMITS AND SPACED 1 MILE APART THEREAFTER.</p> <p>- AT TEE INTERSECTIONS INSTALL INITIALLY 0.5 MILE FROM INTERSECTION AND SPACE 1 MILE APART THEREAFTER.</p>
	<p>A SPEED LIMIT 35 W13-1P 18" X 18"</p>	<p>PLACE INITIALLY AT THE CONSTRUCTION LIMITS AND SPACED 1 MILE APART THEREAFTER. IF NO -Y- LINES EXIST, PLACE 2ND SET 1/2 MILE FROM THE CONSTRUCTION LIMITS AND THEN SPACE 1 MILE THEREAFTER. SPEED LIMIT SIGN MAY BE PLACED ON SAME POST AS LOOSE GRAVEL SIGN, IF DESIRED.</p>
	<p>④ ROAD UNDER CONST SP 13106 48" X 48"</p>	<p>- THESE ARE FOR -Y- LINES THAT ARE "THROUGH" ROADWAYS. DEAD END AND SUBDIVISION ROADS ARE NOT "THROUGH" ROADWAYS.</p> <p>- INSTALL 500' +/- FROM EACH -Y- LINE APPROACH AS SHOWN ABOVE.</p> <p>- FOR MULTIPLE -Y- LINES THAT ARE SEPARATED BY 0.25 MILES OR LESS, TREAT AS A SINGLE UNIT AND INSTALL WITHIN 500' OF EACH APPROACH.</p> <p>- A MAXIMUM OF 2 SIGN SETS PER MILE. DO NOT INSTALL WHEN -Y- LINES ARE WITHIN 0.5 MILES FROM "END ROAD WORK" SIGN.</p>
	<p>⑤ END ROAD WORK G20-2 A 48" X 24"</p>	<p>PLACE 500' FOLLOWING THE END OF CONSTRUCTION LIMITS OR AS SHOWN WHEN WORK ENDS AT A 3-WAY TEE INTERSECTION.</p>
	<p>THE ABOVE SIGNS ARE ALL THAT ARE REQUIRED FOR A CONTRACTOR TO BEGIN A RESURFACING CONTRACT. ANY ADDITIONAL SIGNS REQUESTED BY NCDOT DIVISIONS SHALL BE INSTALLED WITHIN 7 BUSINESS DAYS OF THE START OF CONTRACT WORK.</p>	

STATIONARY SIGNING NOT REQUIRED FOR THE FOLLOWING -Y- LINE CONDITIONS:

- LESS THAN 1000' OF RESURFACING ALONG -Y- LINE
- SUBDIVISION ROADS
- DEAD END ROADS

WHEN PAVING/CONSTRUCTION ACTIVITIES PROCEED ACROSS AN UNSIGNED -Y- LINE, PORTABLE ADVANCE WARNING SIGNS SHALL BE USED ALONG THE -Y- LINE AS SHOWN BELOW. REMOVE UPON COMPLETION OF WORK.

W20-1 48" X 48"

PLACED 500' IN ADVANCE OF FLAGGER.

W20-7 A 48" X 48"

PLACED 250' IN ADVANCE OF FLAGGER.

NOTE:
IT IS THE CONTRACTOR'S RESPONSIBILITY TO ENSURE THE PROPER PLACEMENT AND LOCATION OF WORK ZONE SIGNING PER THE STANDARD DRAWING. NCDOT HAS THE RIGHT TO INSPECT THE PLANNED LOCATIONS AND REQUIRE ADJUSTMENT BY THE CONTRACTOR, AS NEEDED, OR AS DIRECTED BY THE ENGINEER.

MAPS LESS THAN 2 MILES
FOR AST RESURFACING MAPS WITH CONSTRUCTION LIMITS LESS THAN 2 MILES IN LENGTH, USE A STATIONARY "LOOSE GRAVEL" SIGN AT THE BEGINNING CONSTRUCTION LIMIT FOLLOWED BY AN "UNMARKED PAVEMENT" SIGN MIDWAY THROUGH AND AN "END ROAD WORK" SIGN AT THE END CONSTRUCTION LIMIT.

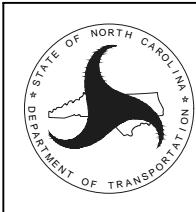

REVISED - 12-13-2018

NCDOT - DIVISION 6

ADVANCE WARNING SIGNS FOR 2-LANE ROADWAY ASPHALT SURFACE TREATMENT

SUMMARY OF QUANTITIES

										PROJECT NO.		SHEET NO.	TOTAL NO.			
										2023CPT.06.07.20782.1						
										1803500000-E	1838000000-E	4413000000-E	4457000000-N			
PROJECT NO	COUNTY	MAP NO	ROUTE	DESCRIPTION	TYP NO	LANES	LANE TYPE	LENGTH		WIDTH	ASPHALT SURFACE TREATMENT, DOUBLE SEAL	EMULSION FOR ASPHALT SURFACE TREATMENT	WORK ZONE ADVANCE/GENERAL WARNING SIGNING	TEMPORARY TRAFFIC CONTROL		
								MI	FT		SY	GAL	SF	LS		
2023CPT.06.07.20782.1	Robeson	1	SR 1763	FROM SR 1318 TO SR 1762	1	2	2WU	2.03	20		26,201	14,411	170	1		
TOTAL FOR MAP NO. 1								2.03			26,201	14,411	170	1		
2023CPT.06.07.20782.1	Robeson	2	SR 1778	FROM SR 1505 TO DEAD END	1	2	2WU	1.5	20		19,360	10,648	84			
TOTAL FOR MAP NO. 2								1.5			19,360	10,648	84			
2023CPT.06.07.20782.1	Robeson	3	SR 1784	FROM SR 1006 TO SR 1318	1	2	2WU	1.63	20		21,038	11,571	112			
TOTAL FOR MAP NO. 3								1.63			21,038	11,571	112			
2023CPT.06.07.20782.1	Robeson	4	SR 1811	FROM SR 1006 TO SR 1752	1	2	2WU	1.25	20		16,133	8,873	112			
TOTAL FOR MAP NO. 4								1.25			16,133	8,873	112			
2023CPT.06.07.20782.1	Robeson	5	SR 1842	FROM SR 1318 TO DEAD END	1	2	2WU	0.25	21		3,388	1,863	84			
TOTAL FOR MAP NO. 5								0.25			3,388	1,863	84			
2023CPT.06.07.20782.1	Robeson	6	SR 1757	FROM SR 1001 TO SR 1758	1	2	2WU	1.24	21		16,804	9,242	112			
TOTAL FOR MAP NO. 6								1.24			16,804	9,242	112			
2023CPT.06.07.20782.1	Robeson	7	SR 1761	FROM SR 1762 TO SR 1758	1	2	2WU	2.12	20		27,362	15,049	175			
TOTAL FOR MAP NO. 7								2.12			27,362	15,049	175			
2023CPT.06.07.20782.1	Robeson	8	SR 1762	FROM SR 1006 TO SR 1758	1	2	2WU	3.25	19		39,849	21,917	238			
TOTAL FOR MAP NO. 8								3.25			39,849	21,917	238			
2023CPT.06.07.20782.1	Robeson	9	SR 1817	FROM SR 1505 TO DEAD END	1	2	2WU	0.39	20		5,034	2,769	84			
TOTAL FOR MAP NO. 9								0.39			5,034	2,769	84			
2023CPT.06.07.20782.1	Robeson	10	SR 1823	FROM SR 1774 TO DEAD END	1	2	2WU	0.56	21		7,589	4,174	84			
TOTAL FOR MAP NO. 10								0.56			7,589	4,174	84			
2023CPT.06.07.20782.1	Robeson	11	SR 1318	FROM SR 1762 TO NC 211	1	2	2WU	6.881	25		111,013	61,057	441			
TOTAL FOR MAP NO. 11								6.881			111,013	61,057	441			
2023CPT.06.07.20782.1	Robeson	12	SR 1594	FROM NC 211 TO SR 1774	1	2	2WU	0.76	21		10,300	5,665	112			
TOTAL FOR MAP NO. 12								0.76			10,300	5,665	112			
2023CPT.06.07.20782.1	Robeson	13	SR 1756	FROM SR 1752 TO SR 1001	1	2	2WU	0.9	18		10,454	5,750	112			
TOTAL FOR MAP NO. 13								0.9			10,454	5,750	112			
2023CPT.06.07.20782.1	Robeson	14	SR 1774	FROM SR 1505 TO SR 1318	1	2	2WU	3.95	24		61,178	33,648	277			
TOTAL FOR MAP NO. 14								3.95			61,178	33,648	277			
2023CPT.06.07.20782.1	Robeson	15	SR 1758	FROM SR 1828 TO SR 1001	1	2	2WU	4.87	20		62,855	34,570	329			
TOTAL FOR MAP NO. 15								4.87			62,855	34,570	329			
2023CPT.06.07.20782.1	Robeson	16	SR 1760	FROM SR 1761 TO MP 0.94 FROM SR 1761	1	2	2WU	0.94	20		12,132	6,673	112			
TOTAL FOR MAP NO. 16								0.94			12,132	6,673	112			
TOTAL FOR PROJ NO. 2023CPT.06.07.20782.1											32.521		450,690	247,880	2,638	1
GRAND TOTAL											32.521		450,690	247,880	2,638	1